

Replacing the nylon inserts on non-rebound Supercraft Mallets:

Replacing

Supercraft inserts

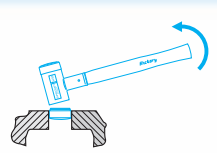

1. Clamp the worn nylon insert firmly in the vice and pull the hammer off upwards.

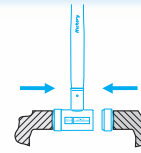

2. With the hammer in the vice, press the new inserts on to the insert retaining pegs.

Replacing the Hickory handle on non-rebound Supercraft Mallets:

Replacing

Supercraft handles



1. Saw the handle off flush with the handle protective sleeve.



2. Use a punch to drive the spring cotter pin out. The spring cotter pin can be reused.

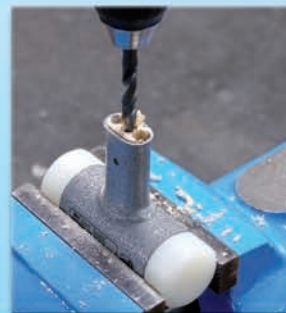

3. Fully remove the rest of the wooden handle in the protective sleeve by drilling out.



4. Position the replacement handle complete with aluminium wedge in the protective sleeve and then press/knock the handle in.



5. Using a 3.8 mm diam. bit, drill through the handle via the specified hole in the handle protective sleeve.



6. Drive in the spring cotter pin until it is flush.

For guarantee and safety reasons please only use Original Halder parts for all Halder Soft Face Mallets